



PORT COLBORNE

• **PLANNING AND DEVELOPMENT DEPARTMENT** •

CITY OF PORT COLBORNE
COMMITTEE OF ADJUSTMENT
66 Charlotte Street
Port Colborne, ON L3K 3C8

COMMITTEE OF ADJUSTMENT
NOTICE OF PUBLIC HEARING
APPLICATION FOR CONSENT

APPLICATION NO. B11-21-PC

IN THE MATTER OF the Planning Act, R.S.O., 1990, c.P.13, Section 53 (1);

AND IN THE MATTER OF the lands legally known as Lots 355 & 356 on Plan 16, the City of Port Colborne, Regional Municipality of Niagara, municipally known as 205 Kent Street.

AND IN THE MATTER OF AN APPLICATION by the owners Wendy & Jacob Bas, for a severance under Section 53 (1) of the Planning Act, R.S.O. 1990, Chapter P, 13 so as to permit the conveyance of Part 1 having a lot frontage of 18.75 m and a lot area of 526.1m² on Fielden Avenue for future residential use. Part 2 will retain a lot frontage of 28.04m on Kent Street with a lot area of 901.5m² for continued residential use. A sketch of the subject lands is shown on the reverse side of this notice.

PLEASE TAKE NOTICE that this application will be heard virtually by the Committee of Adjustment as shown below:

DATE: Wednesday, July 14th, 2021
TIME: 6:00 P.M.
LOCATION: City of Port Colborne Council Chambers - Third Floor (virtual)
66 Charlotte Street, Port Colborne, Ontario

Additional information regarding this application will be available for public inspection by appointment in the office of the Planning and Development Department, during the hours of 8:30 a.m. to 4:30 p.m., Monday to Friday, by telephone at 905-835-2900, Ext. 205 or email at chris.roome@portcolborne.ca

PUBLIC HEARING: You are entitled to participate and express your views about this application or you may be represented by counsel for that purpose. The Planning Division's report may be available for public inspection by **July 9th, 2021**.

Electronic Hearing Procedures

How to get involved in the Virtual Hearing

To prevent the spread of COVID-19, the Committee of Adjustment meeting will be held virtually, with the meeting live-streamed on the City's YouTube channel at <https://youtu.be/KzeM9rE7BlS>.

Anyone wishing to participate in the meeting is asked to submit a written submission that will be circulated to Committee members prior to the meeting. If anyone wishes to virtually participate in the meeting they must pre-register with the Secretary-Treasurer. **Written submissions and virtual participation requests must be received by noon on Tuesday, July 13th, 2021**, by emailing Chris.Roome@portcolborne.ca or calling (905) 835-2901 ext. 205. Written submissions can also be submitted to the mail slot in the front-left of City Hall, 66 Charlotte Street.

If you have any questions about the submission process or would like to explore alternative submission methods, please email Chris.Roome@portcolborne.ca or call (905) 835-2901 ext. 205.

The owner or agent must be present virtually at the Hearing. If you do not attend the Hearing, the Committee may adjourn the file or proceed in your absence and make a decision.

NOTE: If you wish to be notified of the decision of the Committee with respect to this application, you must submit a written request to the Committee of Adjustment. This will also entitle you to be advised of a possible Local Planning Appeal Tribunal hearing if the decision of the Committee is appealed.

By order of the Committee of Adjustment,

Chris Roome, BURPI
Secretary-Treasurer

Date of Mailing: June 29th, 2021

SKETCH PREPARED FOR SEVERANCE/MINOR VARIANCE APPLICATION

THIS IS NOT A PLAN OF SURVEY AND SHALL NOT BE USED FOR ANY PURPOSE OTHER THAN CURRENT SEVERANCE/MINOR VARIANCE APPLICATION. © THIS SKETCH IS PROTECTED BY COPYRIGHT.

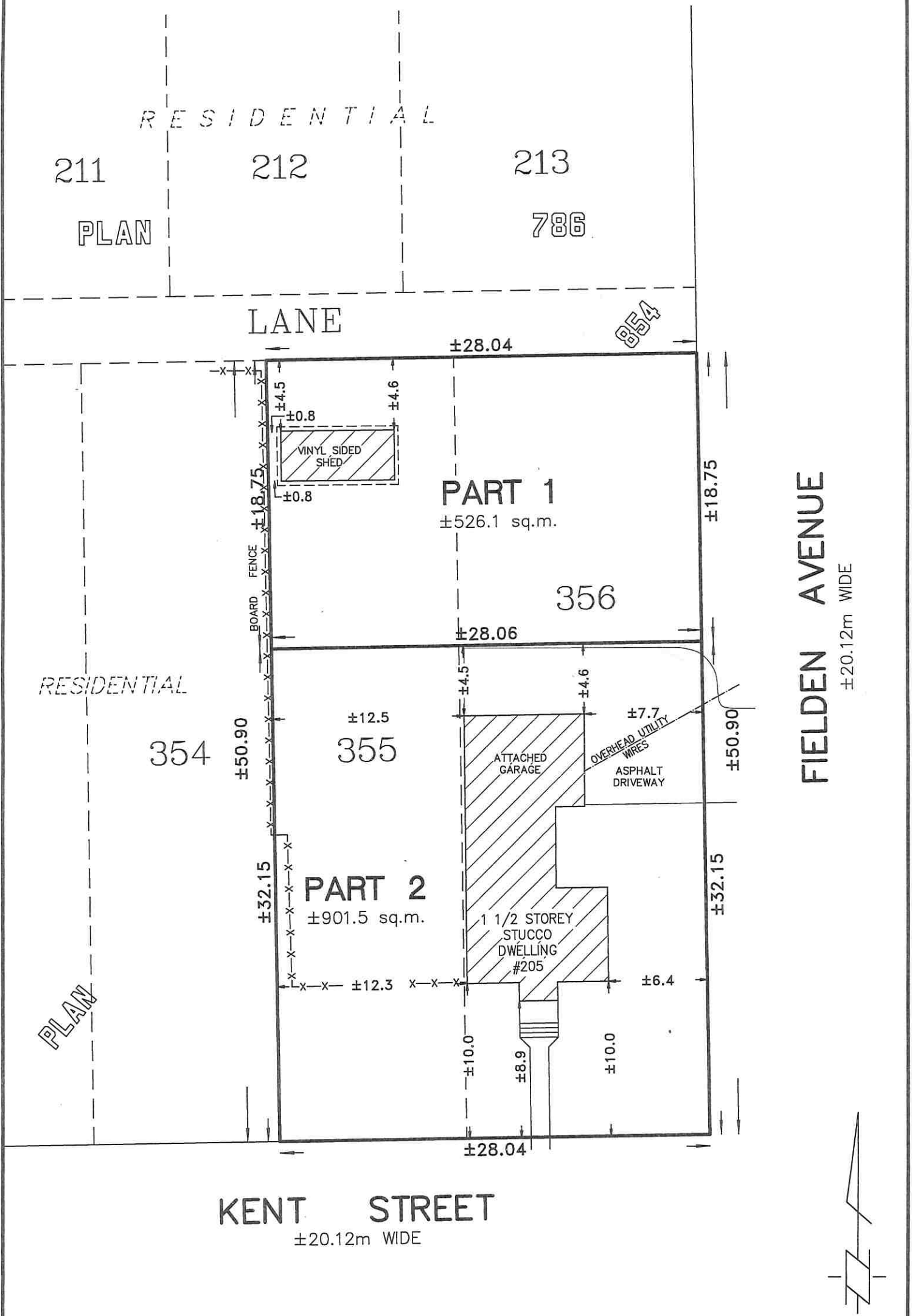

VOID
 IF USED FOR ANY OTHER
 PURPOSE THAN THIS
 CURRENT SEVERANCE/
 MINOR VARIANCE
 APPLICATION

PRELIMINARY
 ONLY

JUNE 4, 2021
 DATE

MARK GILMORE
 Ontario Land Surveyor

LANTHIER & GILMORE SURVEYING LTD.
 173 CLARENCE ST. PORT COLBORNE, ONT. (905) 835-5477

SKETCH OF PROPOSED SEVERANCE/MINOR VARIANCE
 LOTS 355 & 356
 PLAN 854
 IN THE
 CITY OF PORT COLBORNE
 REGIONAL MUNICIPALITY OF NIAGARA

DRAWN BY: CM CHECKED BY: MG
 SCALE: 1:300 SURVEY 22-549

