

WESTWOOD ESTATES - PHASE 3

CITY OF PORT COLBORNE

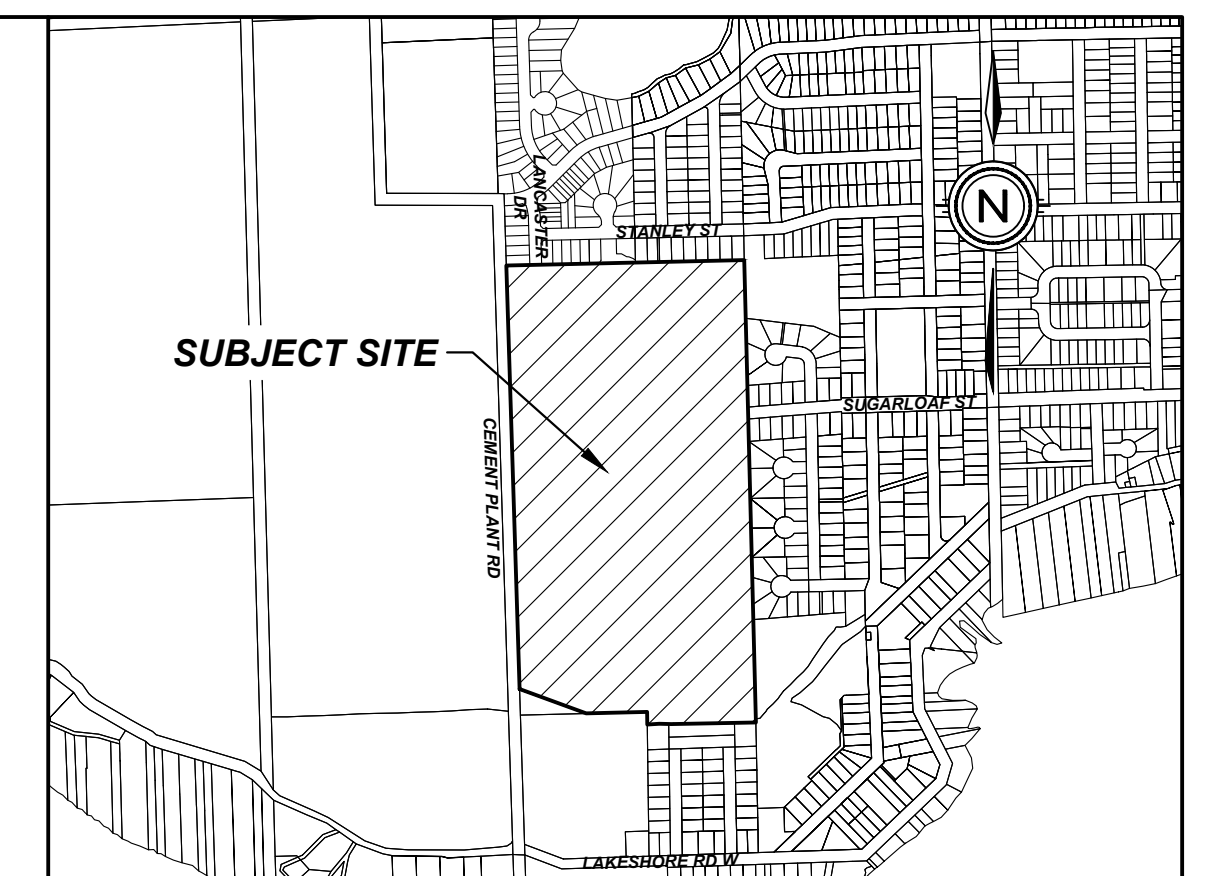
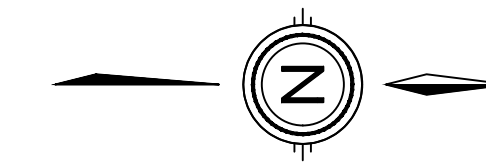

KEY PLAN
N.T.S.

DEMONSTRATION PLAN

LAND USE SCHEDULE

LAND USE	LOT/BLOCK	# OF UNITS	AREA(ha)	AREA(%)
SINGLE FAMILY RESIDENTIAL	LOT 1-167	167	9.222	30.18
STREET TOWN RESIDENTIAL	BLOCK 168-177	52	1.162	3.80
MEDIUM DENSITY RESIDENTIAL	BLOCK 178	96	0.976	3.19
PARKS	BLOCK 179-181		0.535	1.75
TRAIL CONNECTIONS	BLOCK 182-184		0.484	1.58
PROVINCIAL SIGNIFICANT WETLAND	BLOCK 185-186		10.810	35.38
DRAINAGE CHANNEL	BLOCK 187-189		1.489	4.87
STORMWATER MGMT FACILITY	BLOCK 190-191		1.356	4.44
SWM ACCESS	BLOCK 192		0.020	0.07
TRAIL ACCESS	BLOCK 193		0.018	0.06
BUFFER AREAS	BLOCK 194-195		0.075	0.25
ROADWAY			4.407	14.42
TOTAL		315	30.554	100.00

DEVELOPABLE AREA = 18.25ha
DEVELOPABLE DENSITY = 17.26 units/ha

#	ISSUED FOR REVIEW	2023-01-06	M.K
	REVISION	DATE	INIT



DEMONSTRATION PLAN	DRAWING TITLE	DRAFTING	MK
		DATE	NOVEMBER 15, 2022
		PRINTED	JANUARY 6, 2023
		SCALE	1:1250
	DWG No.	2160-DP	REV
			0